

# Unit 16

Littleton House, Ashford  
TW15 1UU

UNIT TYPE Warehouse  
TOTAL AREA 1,364 Sq Ft / 127 Sq M  
RENT £2,160.00 PCM + VAT

A two storey building offering a variety of office and industrial units in Twickenham.



**UNIT TYPE** Warehouse  
**TOTAL AREA** 1,364 Sq Ft / 127 Sq M

**RENT** £2,160.00 PCM + VAT

Prices shown are exclusive of VAT and business rates.  
Service charge and insurance costs may also apply.

## UNIT FEATURES & AMENITIES

- 3 Phase Power
- Energy Efficient Lighting

## EPC RATING

|          |                           |
|----------|---------------------------|
| 0-25     | New rating<br>coming soon |
| 26-50    |                           |
| 51-75    |                           |
| 76-100   |                           |
| 101-125  |                           |
| 126-150  |                           |
| Over 150 |                           |

## DESCRIPTION

RENT INCLUSIVE OF SERVICE CHARGE. Unit 16 is a recently refurbished 1,364 sq.ft light industrial unit in Ashford. The ground floor unit benefits from on-site parking, a property manager and CCTV.

Littleton House is a multi occupied business centre providing a range of individual light industrial/workshop/studio and office units on ground and first floor level.

Formerly a factory, the building offers flexible space suitable for a variety of uses and available on both short-term and long-term basis. All units have separate access with the first floor units benefitting from a large goods lift.

## LOCATION

Littleton House occupies a prominent corner position at the junction of Littleton Road and Ashford Road just off the A308 Staines Road West providing easy access to the M3 and a short distance from Heathrow Airport. Sunbury Station is the closest station which provides access to London Waterloo within 50 minutes.

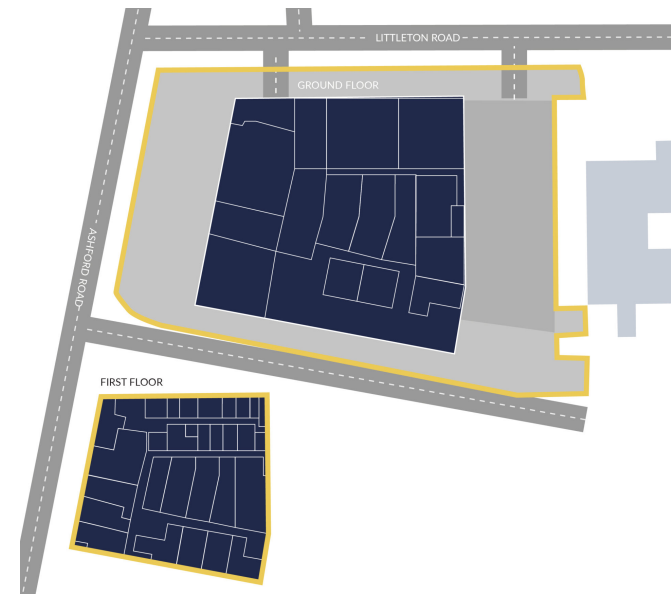
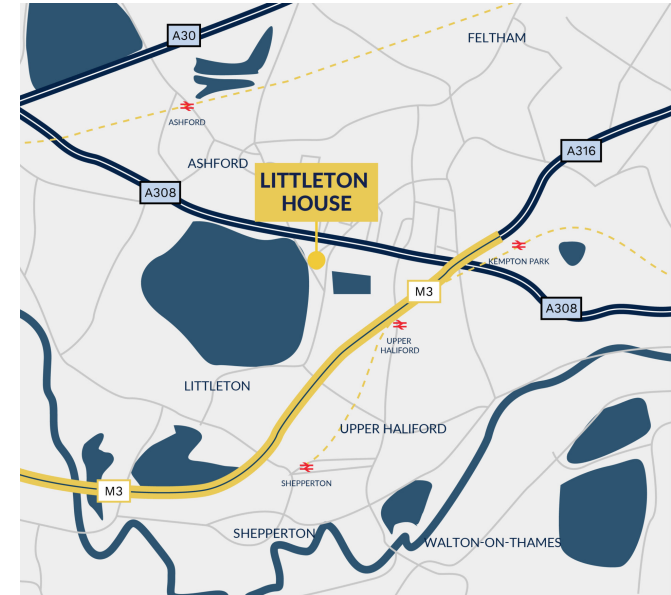

**Finlay Higgins**

+44 (0) 20 7016 1520

fhiggins@capitalindustrial.co.uk

Capital Industrial prepares sales and letting particulars diligently and all reasonable steps are taken to ensure that they are correct. Capital Industrial will not be under any liability to any purchaser or tenant or prospective purchaser or tenant in respect of them. If a property is unoccupied, Capital Industrial may not have all the information required by a prospective purchaser or tenant in its possession, may not be able to obtain it and may not be able to verify all the information which it does hold. The mention of appliances and/or services or heating/cooling system or any other plant or fenestration systems in this description does not imply that they are in working order. Prospective purchasers should make their own investigations before finalising any agreement to purchase or lease. Note: Any maps or plans included in this document are obtained from Promap under our Ordnance Survey Business Use Copyright licence ES 100017692 or are Goad Digital Plans including mapping data licensed from Ordnance Survey Crown Copyright 2007 under licence number PU 100017316